

LX130

HITACHI

LX130

W H E E L L O A D E R

- Engine Rated Power : 129 kW (175 PS)
- Operating Weight : 13 770 kg
- Bucket Capacity : ISO Heaped
2.1 m³ – 3.2 m³

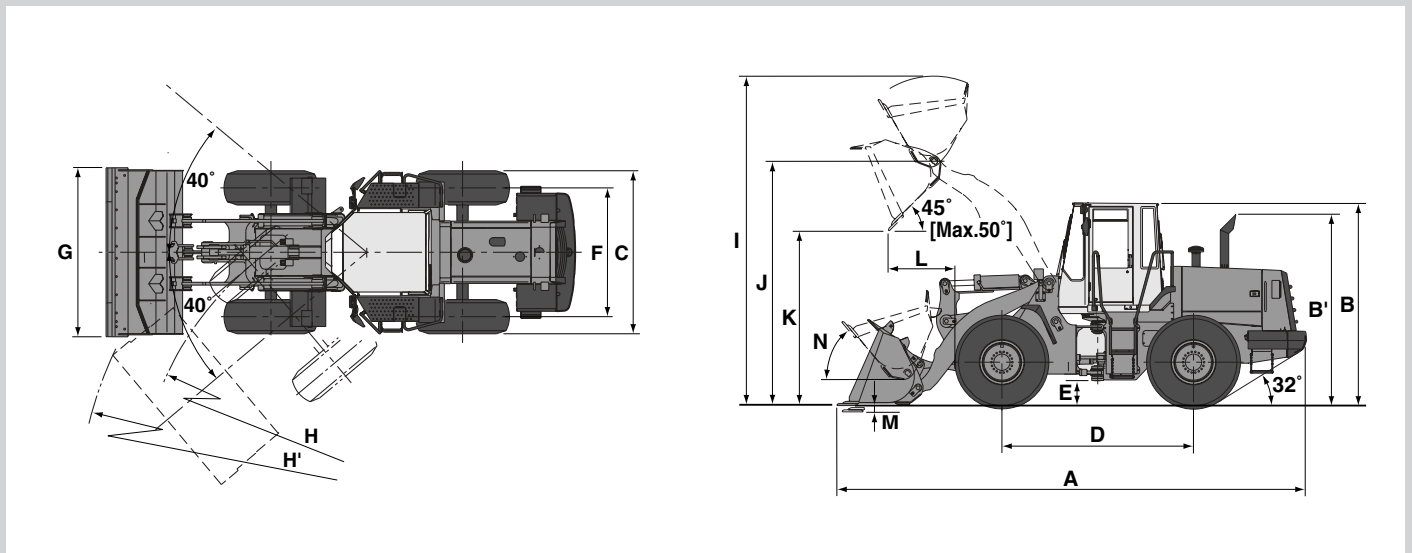

Unit : mm

	LX130-7
A Overall length	7 520
B Height to top of cab	3 240
B' Height to top of exhaust	3 040
C Width over tires	2 610
D Wheel base	3 050
E Ground clearance	405
F Tread	2 050
G Bucket width	2 690
H Turning radius (Centerline of outside tire)	5 230
H' Loader clearance circle, bucket in carry position	6 100
I Overall operating height	5 250
J Height to bucket hinge pin, fully raised	3 890
K Dumping clearance 45 degree, full height	2 770
L Reach, 45 degree dump, full height	1 060
Reach, 45 degree dump, 7 ft (2.13 m) clearance	1 555
M Digging depth (Horizontal digging angle)	100
N Max. roll back at carry position	50 deg.
Tire size	20.5 - 25 - 12PR (L3)

Note: General purpose bucket with bolt on cutting edges.



ENGINE

Model Isuzu BB-6HK1T
 Type 4-cycle water-cooled, direct injection
 Aspiration Turbocharger
 No. of cylinders 6
 Rated power
 DIN 6 272, net 129 kW (175 PS) at 2 300 min⁻¹ (2 300 rpm)
 SAE J1349, net 129 kW (173 HP) at 2 300 min⁻¹ (2 300 rpm)
 Bore and stroke 115 mm x 125 mm
 Piston displacement 7.790 L
 Electrical system 24 V with 0.96 kW, 50 A alternator
 Starting system 24 V x 5.0 kW electric motor
 Batteries 2 x 12 V / 916 CCA, 270-min. rated reserve
 Air cleaner Two element dry type with restriction indicator



POWER TRAIN

Transmission Torque converter, countershaft type powershift with computer-controlled automatic shift and manual shift features included.
 Torque converter Three element, single stage, single phase
 Main clutch Wet hydraulic, multi-disc type
 Cooling method Forced circulation type
 Travel speed* : km/h

	Forward / Reverse
1st	7.5 / 8.0
2nd	12.0 / 13.5
3rd	22.0 / 24.0
4th	34.5 / 37.0

*With 20.5-25-12PR (L3) tires



AXLE AND FINAL DRIVE

Drive system Four-wheel drive system
 Front & rear axle Semi-floating
 Front : Fixed to the front frame
 Rear : Trunnion support
 Reduction and differential gear Two stage reduction with torque proportional differential
 Oscillation angle ±12° ; total 24°
 Final drives Heavy-duty planetary, mounted inboard



TIRES (tubeless, nylon body)

Standard 20.5-25-12PR (L3)
 Optional Refer to standard & optional equipment list



BRAKES

Service brakes Inboard mounted fully hydraulic 4 wheel wet disc brake.
 Front & rear independent brake circuit
 Parking brake Wet multiple disc mechanical type built in transmission



STEERING SYSTEM

Type Articulated frame steering
 Steering mechanism Full hydraulic power steering with orbital
 Steering angle Each direction 40° ; total 80°
 Relief pressure 18.6 MPa (190 kgf/cm²)
 Cylinders Two double-acting piston type
 No. x Bore x Stroke 2 x 80 mm x 422 mm
 Minimum turning radius at the centerline of outside tire 5.23 m



HYDRAULIC SYSTEM

Arm and bucket are controlled by independent control lever
 Arm controls Four position valve ; Raise, hold, lower, float
 Bucket controls with automatic bucket return-to-dig control Three position valve ; Roll back, hold, dump
 Main pump Gear type 100 L/min @2 300 min⁻¹ (rpm) at 17 160 KPa (175 kgf/cm²)
 Steering pump Gear type 141 L/min @2 300 min⁻¹ (rpm) at 20 590 KPa (210 kgf/cm²)
 Brake and assist pump Gear type 29 L/min @2 300 min⁻¹ (rpm) at 4 410 KPa (45 kgf/cm²)
 Charging pump Double gear type with two discharge ports
 Front pump Front 86 L/min @2 300 min⁻¹ (rpm) at 2 450 KPa (25 kgf/cm²)
 Rear pump Rear 40 L/min @2 300 min⁻¹ (rpm) at 490 KPa (5 kgf/cm²)
 Relief pressure setting 20 590 KPa (210 kgf/cm²)
 Hydraulic cylinders
 Type Two arm and one bucket, double acting type
 No. x Bore x Stroke Arm : 2 x 140 mm x 760 mm
 Bucket : 1 x 170 mm x 495 mm
 Filters Full-flow 15 micron return filter in reservoir
 Hydraulic cycle times
 Lift arm raise 5.8 s
 lower 3.3 s
 Bucket dump 1.4 s
 Total 10.5 s



SERVICE REFILL CAPACITIES

Fuel tank 230 L
 Engine coolant 47.5 L
 Engine oil 19 L
 Torque convertor & transmission 25 L
 Front axle differential & wheel hubs 28 L
 Rear axle differential & wheel hubs 28 L
 Hydraulic reservoir 80 L



DIMENSIONS & SPECIFICATIONS

Arm type			Standard arm					
			General purpose			Rock bucket		Light material handling
			With bolt-on cutting edges	With bolt-on teeth	With bolt-on teeth & segments	With bolt-on teeth	With bolt-on teeth & segments	With bolt-on cutting edges
Bucket capacity	ISO heaped	m ³	2.7	2.6	2.7	2.2	2.2	3.2
	ISO struck	m ³	2.3	2.2	2.3	1.9	1.9	2.8
Bucket width		mm	2 690	2 690	2 690	2 690	2 690	2 690
Working range								
Dumping clearance 45 degree, full height		mm	2 770	2 670	2 670	2 745	2 745	2 665
Reach, 45 degree dump, full height		mm	1 060	1 130	1 130	1 065	1 065	1 175
Reach, 45 degree dump, 7 ft (2.13 m) clearance		mm	1 555	1 580	1 580	1 550	1 550	1 615
Reach with arm horizontal and bucket level		mm	2 465	2 600	2 600	2 500	2 500	2 625
Digging depth (Horizontal digging angle)		mm	100	110	110	110	110	100
Overall operating height		mm	5 250	5 250	5 250	5 200	5 200	5 350
Overall length (Bucket on ground)		mm	7 520	7 660	7 660	7 560	7 560	7 675
Loader clearance circle, bucket in carry position		mm	6 100	6 140	6 140	6 110	6 110	6 140
Static tipping load *	Straight	kgf	11 000	10 800	10 700	10 450	10 350	10 600
	Full 40 degree turn	kgf	9 500	9 300	9 200	9 000	8 850	9 100
Breakout force		kN (kgf)	125 (12 700)	136 (13 900)	129 (13 200)	149 (15 200)	141 (14 400)	110 (11 200)
Operating weight *		kgf	13 700	13 640	13 760	14 120	14 240	13 790

Arm type			High-lift arm		Standard arm with quick coupler			
			General purpose		General purpose		Light material handling	
			With bolt-on cutting edges	With bolt-on teeth	With bolt-on cutting edges	With bolt-on teeth	With bolt-on cutting edges	
Bucket capacity	ISO heaped	m ³	2.3	2.1	2.3	2.1	2.7	
	ISO struck	m ³	2.0	1.8	2.0	1.8	2.4	
Bucket width		mm	2 690	2 690	2 690	2 690	2 690	
Working range								
Dumping clearance 45 degree, full height		mm	3 295	3 190	2 720	2 620	2 665	
Reach, 45 degree dump, full height		mm	1 035	1 105	1 120	1 190	1 175	
Reach, 45 degree dump, 7 ft (2.13 m) clearance		mm	1 915	1 940	1 590	1 600	1 615	
Reach with arm horizontal and bucket level		mm	2 685	2 820	2 545	2 680	2 625	
Digging depth (Horizontal digging angle)		mm	160	170	100	110	100	
Overall operating height		mm	5 580	5 580	5 300	5 300	5 480	
Overall length (Bucket on ground)		mm	7 820	7 970	7 595	7 740	7 675	
Loader clearance circle, bucket in carry position		mm	6 240	6 290	6 150	6 200	6 180	
Static tipping load *	Straight	kgf	10 100	10 200	9 800	9 850	9 700	
	Full 40 degree turn	kgf	8 750	8 800	8 400	8 450	8 300	
Breakout force		kN (kgf)	130 (13 300)	144 (14 700)	121 (12 300)	130 (13 300)	114 (11 600)	
Operating weight *		kgf	14 170	14 100	14 240	14 170	14 310	

Notes: 1. All dimensions, weight and performance data based on ISO 6746-1:1987, ISO 7131:1997 and ISO 7546:1983

2. Static tipping load and operating weight marked with * include 20.5-25-12PR (L3) tires (No ballast) with lubricants, coolant, full fuel tank and operator. Machine stability and operating weight depend on counterweight, tire size and other attachments.

 **Hitachi Construction Machinery Co., Ltd.**

Head Office: 5-1 Koraku 2-chome, Bunkyo-ku,
Tokyo 112-8563, Japan

Telephone: (03)3830-8050

Facsimile: (03)3830-8204

*These specifications are subject to change without notice.
Illustrations and photos show the standard models, and may or may not include optional
equipment, accessories, and all standard equipment with some differences in color and features.
Before use, go through Operators Manual for proper operation.*

KL-E121

03.09 (KA/KA, MT₃)

Printed in Japan